

PN SERIES: PARAGON™ PLANETARY GEARHEADS

SINGLE, DOUBLE, TRIPLE STAGE PRECISION GEARHEADS

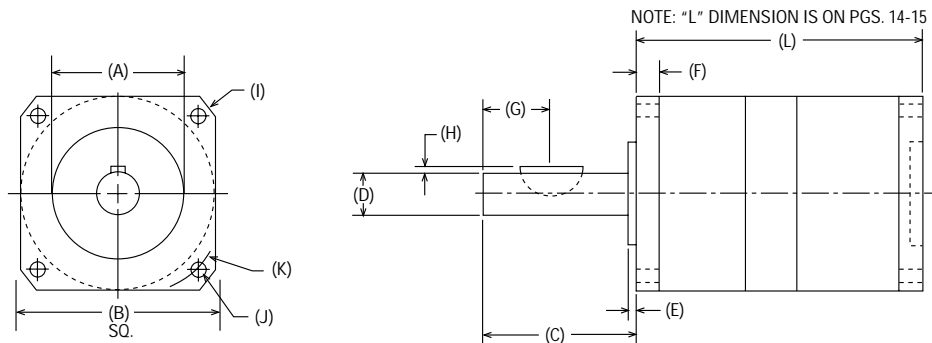

PART NUMBER	A PILOT DIAMETER (in.)	B SQUARE FLANGE (in.)	C SHAFT LENGTH (in.)	D SHAFT DIAMETER (in.)	E PILOT LENGTH (in.)	F FLANGE THICKNESS (in.)	G KEY LOCATION (in.)
017PNX	.864/.866	1.65	1.25	.4995/.5000	0.062	0.187	0.56
023PNX	1.498/1.500	2.25	1.25	.4995/.5000	0.062	0.250	0.56
034PNX	2.873/2.875	3.25	1.50	.7495/.7500	0.062	0.375	0.56
042PNX	2.185/2.187	4.20	2.00	.9995/1.0000	0.062	0.500	0.63
056PNX	4.498/4.500	5.75	2.50	1.4995/1.5000	0.125	0.750	0.94
075PNX	5.998/6.000	7.48	3.50	1.9995/2.0000	0.187	0.875	3.00 Lg

PART NUMBER	H KEY HEIGHT (in.)	I HOUSING DIAMETER (in.)	J BOLT HOLE DIAMETER (in.)	K BOLT HOLE CIRCLE (in.)	KEY WIDTH/ WOODRUFF KEY (in.)	RADIAL & AXIAL SHAFT LOADING (LBS.)
017PNX	0.063	2.05	0.125	1.725	0.125 / #404	SEE PAGE 17
023PNX	0.063	2.95	0.205	2.625	0.125 / #404	
034PNX	0.094	4.38	0.220	3.875	0.187 / #606	
042PNX	0.125	5.51	0.280	4.950	0.250 / #808	
056PNX	0.187	7.87	0.410	7.000	0.375 / #1212	
075PNX	0.157	9.64	0.560	8.465	3/8" x 5/8" RECT.	

AVAILABLE RATIOS	EFFICIENCY	SPECIFICATIONS
SINGLE STAGE : 3:1 / 4:1 / 5.5:1 / 7:1 / 10:1	90%	Input RPM: 5000 Max.
DOUBLE STAGE: 16:1 / 22:1 / 28:1 / 40:1 / 49:1 / 55:1 / 70:1 / 100:1	85%	Operating Temperature Range -60°F to +255°F Motor Mounting Hardware Supplied

A CGI EXCLUSIVE...

Developed for CGI by
UTS
Software
www.uts.com

Gear sizing software to help you
get the right product for your project.
SIZE IT...GEAR SIZING MADE EASY!



CGI, INC.

SIZE IT

Gear Sizing Software

www.cgimotion.com

ALL SPECIFICATIONS SUBJECT TO CHANGE.

PN SERIES: PARAGON™ PLANETARY GEARHEADS

SINGLE, DOUBLE STAGE

MODEL	RATIO	TORQUE RATING		INERTIA		BACKLASH	GEARHEAD	L
		T _c IN LBS.	T _{PEAK} IN LBS.	INPUT PINION OZ IN SEC ²	GEARHEAD OZ IN SEC ²	STD/ LOW ARC MINUTES	WEIGHT LBS.	GEARHEAD LENGTH
017PNX	3:1	125	174	2.163E-04	1.669E-04	10 / 7	1.0	2.66
017PNX	4:1	119	165	1.352E-04	1.053E-04	10 / 7	1.0	2.66
017PNX	5.5:1	107	149	1.174E-04	5.870E-05	10 / 7	1.0	2.66
017PNX	7:1	89	124	1.143E-04	3.692E-05	10 / 7	1.0	2.66
017PNX	10:1	56	84	1.132E-04	1.833E-05	10 / 7	1.0	2.66
017PNX	16:1	127	176	1.352E-04	1.045E-04	14 / 9	1.6	3.32
017PNX	22:1	128	178	1.174E-04	5.830E-05	14 / 9	1.6	3.32
017PNX	28:1	129	179	1.143E-04	3.667E-05	14 / 9	1.6	3.32
017PNX	40:1	131	181	1.132E-04	1.821E-05	14 / 9	1.6	3.32
017PNX	49:1	95	132	1.143E-04	3.479E-05	14 / 9	1.6	3.32
017PNX	55:1	117	162	1.132E-04	1.755E-05	14 / 9	1.6	3.32
017PNX	70:1	96	134	1.132E-04	1.729E-05	14 / 9	1.6	3.32
017PNX	100:1	52	77	1.132E-04	1.708E-05	14 / 9	1.6	3.32
023PNX	3:1	285	396	1.194E-03	4.866E-04	10 / 7	2.0	3.06
023PNX	4:1	264	366	9.502E-04	3.113E-04	10 / 7	2.0	3.06
023PNX	5.5:1	238	330	8.969E-04	1.746E-04	10 / 7	2.0	3.06
023PNX	7:1	197	274	8.880E-04	1.100E-04	10 / 7	2.0	3.06
023PNX	10:1	119	179	8.846E-04	5.471E-05	10 / 7	2.0	3.06
023PNX	16:1	282	391	9.502E-04	3.287E-04	14 / 9	3.0	3.97
023PNX	22:1	285	396	8.969E-04	1.838E-04	14 / 9	3.0	3.97
023PNX	28:1	288	400	8.880E-04	1.157E-04	14 / 9	3.0	3.97
023PNX	40:1	291	405	8.846E-04	5.749E-05	14 / 9	3.0	3.97
023PNX	49:1	213	295	8.880E-04	1.098E-04	14 / 9	3.0	3.97
023PNX	55:1	260	362	8.846E-04	5.543E-05	14 / 9	3.0	3.97
023PNX	70:1	215	298	8.846E-04	5.460E-05	14 / 9	3.0	3.97
023PNX	100:1	110	164	8.846E-04	5.393E-05	14 / 9	3.0	3.97
034PNX	3:1	964	1339	4.901E-03	4.672E-03	10 / 7	7.0	4.56
034PNX	4:1	914	1270	2.522E-03	2.833E-03	10 / 7	7.0	4.56
034PNX	5.5:1	835	1160	2.040E-03	1.585E-03	10 / 7	7.0	4.56
034PNX	7:1	701	934	1.955E-03	9.983E-04	10 / 7	7.0	4.56
034PNX	10:1	507	704	1.923E-03	4.961E-04	10 / 7	7.0	4.56
034PNX	16:1	986	1370	2.522E-03	2.824E-03	14 / 9	8.0	5.83
034PNX	22:1	1000	1389	2.040E-03	1.580E-03	14 / 9	8.0	5.83
034PNX	28:1	1009	1402	1.955E-03	9.952E-04	14 / 9	8.0	5.83
034PNX	40:1	1023	1421	1.923E-03	4.946E-04	14 / 9	8.0	5.83
034PNX	49:1	762	1058	1.955E-03	9.417E-04	14 / 9	8.0	5.83
034PNX	55:1	924	1283	1.923E-03	4.759E-04	14 / 9	8.0	5.83
034PNX	70:1	770	1070	1.923E-03	4.684E-04	14 / 9	8.0	5.83
034PNX	100:1	507	761	1.923E-03	4.623E-04	14 / 9	8.0	5.83

ALL SPECIFICATIONS SUBJECT TO CHANGE.

PN SERIES: PARAGON™ PLANETARY GEARHEADS

SINGLE, DOUBLE STAGE

MODEL	RATIO	TORQUE RATING		INERTIA		BACKLASH	GEARHEAD	L
		T _c IN LBS.	T _{PEAK} IN LBS.	INPUT PINION OZ IN SEC ²	GEARHEAD OZ IN SEC ²	STD/ LOW ARC MINUTES	WEIGHT LBS.	GEARHEAD LENGTH
042PNX	3:1	1726	2398	1.680E-02	1.641E-02	10 / 7	12.0	5.20
042PNX	4:1	1646	2287	1.032E-02	1.049E-02	10 / 7	12.0	5.20
042PNX	5.5:1	1516	2106	8.997E-03	5.878E-03	10 / 7	12.0	5.20
042PNX	7:1	1283	1782	8.766E-03	3.704E-03	10 / 7	12.0	5.20
042PNX	10:1	936	1300	8.680E-03	1.841E-03	10 / 7	12.0	5.20
042PNX	16:1	1784	2478	1.032E-02	1.101E-02	14 / 9	18.0	6.80
042PNX	22:1	1810	2515	8.997E-03	6.156E-03	14 / 9	18.0	6.80
042PNX	28:1	1829	2540	8.766E-03	3.875E-03	14 / 9	18.0	6.80
042PNX	40:1	1855	2577	8.680E-03	1.925E-03	14 / 9	18.0	6.80
042PNX	49:1	1400	1945	8.766E-03	3.706E-03	14 / 9	18.0	6.80
042PNX	55:1	1688	2344	8.680E-03	1.866E-03	14 / 9	18.0	6.80
042PNX	70:1	1417	1969	8.680E-03	1.843E-03	14 / 9	18.0	6.80
042PNX	100:1	1024	1423	8.680E-03	1.823E-03	14 / 9	18.0	6.80
056PNX	3:1	3877	5385	5.794E-02	7.141E-02	10 / 7	28.0	8.16
056PNX	4:1	3710	5153	3.123E-02	4.524E-02	10 / 7	28.0	8.16
056PNX	5.5:1	3425	4758	2.564E-02	2.527E-02	10 / 7	28.0	8.16
056PNX	7:1	2916	4051	2.470E-02	1.590E-02	10 / 7	28.0	8.16
056PNX	10:1	2143	2977	2.435E-02	7.899E-03	10 / 7	28.0	8.16
056PNX	16:1	4047	5622	3.123E-02	4.702E-02	14 / 9	43.0	10.30
056PNX	22:1	4111	5711	2.564E-02	2.621E-02	14 / 9	43.0	10.30
056PNX	28:1	4157	5774	2.470E-02	1.648E-02	14 / 9	43.0	10.30
056PNX	40:1	4220	5862	2.435E-02	8.184E-03	14 / 9	43.0	10.30
056PNX	49:1	3204	4451	2.470E-02	1.576E-02	14 / 9	43.0	10.30
056PNX	55:1	3845	5341	2.435E-02	7.932E-03	14 / 9	43.0	10.30
056PNX	70:1	3246	4509	2.435E-02	7.830E-03	14 / 9	43.0	10.30
056PNX	100:1	2361	3279	2.435E-02	7.746E-03	14 / 9	43.0	10.30
075PNX	3:1	10005	36975	1.936E-01	2.930E-01	10 / 7	66.0	10.41
075PNX	4:1	9535	13245	6.554E-02	1.889E-01	10 / 7	66.0	10.41
075PNX	5.5:1	9574	13300	4.015E-02	1.062E-01	10 / 7	66.0	10.41
075PNX	7:1	8107	11261	3.574E-02	6.702E-02	10 / 7	66.0	10.41
075PNX	10:1	5959	8277	3.410E-02	3.335E-02	10 / 7	66.0	10.41
075PNX	16:1	11474	15938	6.554E-02	1.928E-01	14 / 9	105.0	13.29
075PNX	22:1	11671	161212	4.015E-02	1.083E-01	14 / 9	105.0	13.29
075PNX	28:1	11810	16405	3.574E-02	6.831E-02	14 / 9	105.0	13.29
075PNX	40:1	12005	16676	3.410E-02	3.398E-02	14 / 9	105.0	13.29
075PNX	49:1	8976	12469	3.574E-02	6.523E-02	14 / 9	105.0	13.29
075PNX	55:1	10848	15069	3.410E-02	3.291E-02	14 / 9	105.0	13.29
075PNX	70:1	9100	12641	3.410E-02	3.247E-02	14 / 9	105.0	13.29
075PNX	100:1	6447	9184	3.410E-02	3.212E-02	14 / 9	105.0	13.29

ALL SPECIFICATIONS SUBJECT TO CHANGE.

NOTES: Other ratios are also available, consult factory.
 T_c: Output torque is rated at 3000 RPM, and a minimum life of 10,000 hours.
 Bearing load ratings are based on a minimum life of 10,000 hours.