

RS/DS SERIES: SPUR RIGHT ANGLE GEARHEADS

NEMA DIMENSIONS-SINGLE OR DOUBLE SHAFT PRECISION GEARHEADS

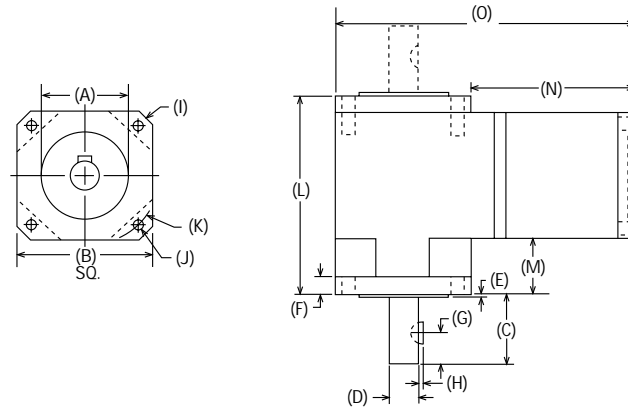

PART NUMBER	A PILOT DIAMETER (in.)	B SQUARE FLANGE (in.)	C SHAFT LENGTH (in.)	D SHAFT DIAMETER (in.)	E PILOT LENGTH (in.)	F FLANGE THICKNESS (in.)	G KEY LOCATION (in.)	H KEY HEIGHT (in.)
023RSX/023DSX	1.498/1.500	2.25	1.25	.4995/.5000	0.062	0.312	0.56	0.063
034RSX/034DSX	2.873/2.875	3.25	1.50	.7495/.7500	0.062	0.312	0.56	0.094
042RSX/042DSX	2.185/2.187	4.20	2.00	.9995/1.0000	0.062	0.500	0.63	0.125
056RSX/056DSX	4.498/4.500	5.75	2.50	1.4995/1.5000	0.125	0.750	0.94	0.187
PART NUMBER	I HOUSING DIAMETER (in.)	J BOLT HOLE DIAMETER (in.)	K BOLT HOLE CIRCLE (in.)	L RIGHT ANGLE WIDTH (in.)	M OVERHANG WIDTH (in.)	KEY WIDTH/ WOODRUFF KEY (in.)	RADIAL SHAFT LOADING (LBS.)	AXIAL SHAFT LOADING (LBS.)
023RSX/023DSX	2.95	0.205	2.625	3.55	0.99	0.125 / #404	300	300
034RSX/034DSX	4.38	0.220	3.875	5.14	1.38	0.187 / #606	500	500
042RSX/042DSX	5.51	0.280	4.950	5.89	1.18	0.250 / #808	700	700
056RSX/056DSX	7.87	0.410	7.000	8.79	2.28	0.375 / #1212	900	900
PART NUMBER	N LENGTH TO FLANGE (in.)	O GEARHEAD LENGTH (in.)	BACKLASH STD/LOW (ARC-MINUTES)	CONTINUOUS TORQUE MAX. (IN LBS.)	MOMENTARY TORQUE MAX. (IN LBS.)	GEARHEAD WEIGHT (LBS.)	MAX. INERTIA REFLECTED TO INPUT (OZ. IN. SEC ²)	PINION GEAR INERTIA (OZ. IN. SEC ²)
023RSX/023DSX	2.67	4.92	25/15	20	30	4.0	2.58 x 10 ⁻⁵	7.59 x 10 ⁻⁴
034RSX/034DSX	3.49	6.74	25/15	60	90	9.0	2.09 x 10 ⁻⁴	1.52 x 10 ⁻³
042RSX/042DSX	4.01	8.21	25/15	200	300	24.0	6.69 x 10 ⁻⁴	7.59 x 10 ⁻³
056RSX/056DSX	5.43	11.23	25/15	350	500	44.0	1.73 x 10 ⁻³	4.57 x 10 ⁻²

AVAILABLE RATIOS AND SHAFT ROTATION*						SPECIFICATIONS
SIZE 023	3:1	SAME	SIZE 034	3:1	SAME	Input RPM: 4000 Max. Minimum Efficiency: 90% Operating Temperature Range -60°F to +250°F Note: Size 056 Requires a Mounting Adapter Motor Mounting Hardware Supplied
	5:1	SAME		5:1	SAME	
	10:1	SAME		10:1	SAME	
	15:1	OPPOSITE		15:1	SAME	
	20:1	OPPOSITE		20:1	OPPOSITE	
	30:1	OPPOSITE		30:1	OPPOSITE	
	50:1	OPPOSITE		50:1	SAME	
	100:1	SAME		100:1	SAME	
SIZE 042	3:1	SAME	SIZE 056	3:1	SAME	
	5:1	SAME		5:1	SAME	
	10:1	SAME		10:1	OPPOSITE	
	15:1	OPPOSITE		15:1	OPPOSITE	
	20:1	OPPOSITE		25:1	OPPOSITE	
	30:1	SAME		40:1	SAME	
	50:1	OPPOSITE				
	100:1	SAME				

ALL SPECIFICATIONS SUBJECT TO CHANGE.

*Rotation references the gearhead output shaft direction with respect to motor shaft direction.